

# MASTECH®

## MS6810

### MULTI-NETWORK CABLE TESTER User's Manual

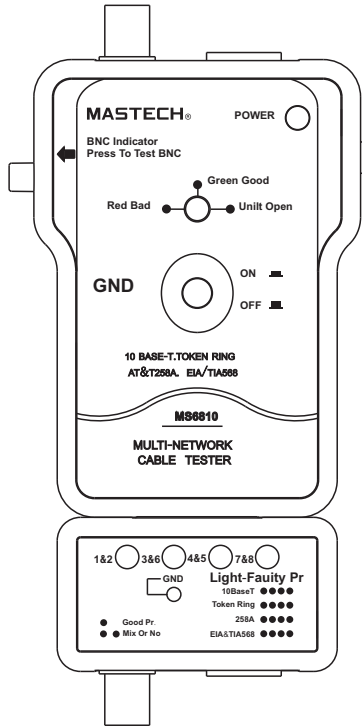

# MASTECH®

## Annex A

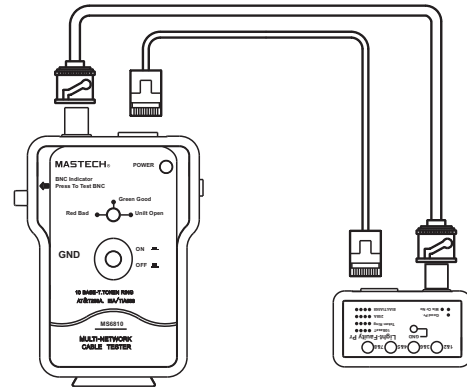

## Annex B

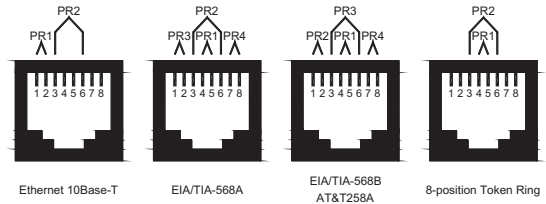

# MASTECH®

## Introduction

The multi-network cable tester is widely used for Coaxial Cable (BNC), UTP and STP Cable. It can automatically check for open circuits, shorts, miswires, and reversals.

1. RJ45 SOCKET
2. POWER INDICATOR
3. POWER SWITCH
4. MASTER UNIT
5. CABLE PAIRS INDICATOR
6. RJ45 SOCKET
7. BNC SOCKET
8. REMOTE TERMINATOR
9. GND BUTTON
10. BNC BUTTON
11. BNC INDICATOR
12. BNC SOCKET

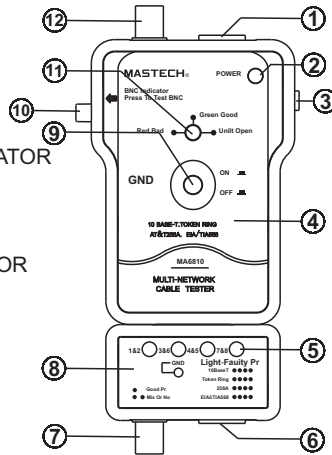

## Caution

**Do NOT use on live circuits.**

### Test for twisted-wire-pair cables (RJ45)

The instrument can be used for 10Base-T, EIA/TIA-568A, EIA/TIA-568B, AT&T258A, and Token Ring Cable.

1. Connect the master unit to one end of the cable to be tested, and connect the remote terminator to the other end.

# MASTECH®

2. Push the power switch to ON, the power indicator will flash to show the power is working properly.
3. The cable pairs indicator on the remote terminator will light one by one. If the indicator is lighted GREEN, the corresponding twisted wire pair is OK. If the indicator is lighted RED or it is unlighted, the corresponding twisted wire pair is fail.
4. If the cable is shield (STP), you may test the cable's shield integrity. Press and hold down GND button, the corresponding indicator and GND indicator will light up with all green except the indicator of pair 3&6 is kept off. If GND indicator is lighted red or unlighted, it's showing the shield is fail.

### Test for coaxial cable (BNC)

1. Connect the master unit to one end of the coaxial cable to be tested, and connect the remote terminator to the other end.
2. Push the power switch ON, the power indicator will flash to show the power is working properly.
3. After the cable is inserted, the BNC indicator should be kept unlighted. If the BNC indicator is lighted up, then the cable is fail.
4. Press and hold down BNC button which is on the left side of the master unit, the BNC indicator will light up GREEN if the cable is OK. If indicator lights up RED or no light, the cable is fail.

## Note

**Please make sure the battery has been installed correctly (9 volt 6F22).**